



**O-Crystal /** SERIES  
**Outdoor transparent**  
Led Screen

**Distributeur Suisse**



Nicolas OBERSON  
nico@streaming-live.me  
Rte du Péleret 10 D: +41 79 366 81 27  
CH - 1691 Villarimboud



[www.onedisplaygroup.com](http://www.onedisplaygroup.com)

**One Display Limited**

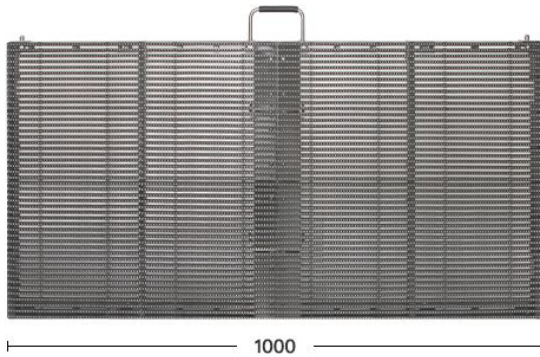

500



## Parameters

### SPECIFICATION

Pixel Pitch	3.9–7.8mm	5.2–10.4mm	10.4mm	15.6mm
Encapsulation brand	NationStar			
LED lamp bead model	SMD1912	SMD1921	SMD2727	SMD2727
Pixel composition	1R1G1B			
Module Reslution(W*H)	128x32 dot	96x24 dot	48x24 dot	32x16 dot
Module Size(W*H)	500x250mm			
Module Fixed Way	Front & Real Access (Screw)			
Panel Reslution(W*H)	256x64 dot	192x48 dot	96x48 dot	64x32 dot
Panel Size(W*H*D)	1000x500mm			
Module Arrangement(W*H)	2x2			
Panel Weight (kg/sqm)	15kg			
Panel Material	Aluminum Die-casting			
Flatness between modules	≤0.1mm			
Maintenance Way	Rear Access			
Density of Pixel (dots/m2)	32768	18432	9216	4096
Brightness(cd/m2)	4500	4500	4500	6500
Viewing angle	140°/140°			
Transparency rate	55%	58%	58%	72%
Contrast	6000:1			
Protection level	Ip65			
Gray scale	14bit			
Chromaticity uniformity	±0.003 within Cx,Cy			
Scan mode	1/8	1/4	1/2	Static
Frame change frequency	60			
Refresh rate	<3840			
Color temperature	2000K~9500K			
Operating platform	Windows XP /7/8/10			
Signal Input	HDMI、DVI			
Operating Voltage	AC: 110V~240V、50~60Hz			
Maximum Power (W/m2)	800			
Average power (W/m2)	240			
Continuous working time	≥7x24hrs			
Service life	100000Hours			
Operating environment	0℃~40℃ 35%~85%RH			



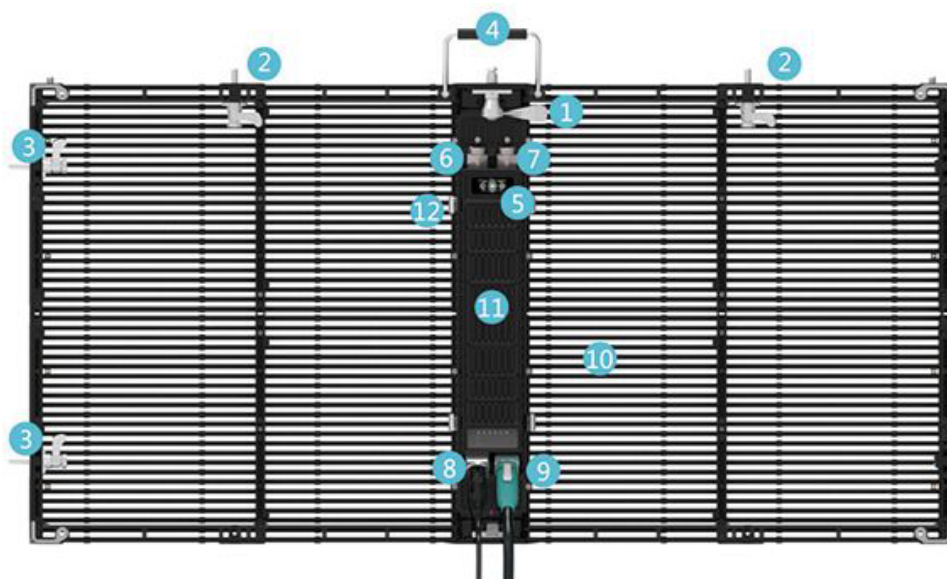

1. Main Lock	4. Handle	7. Power Output Air-plug	10. Module
2. Mate Lock	5. Signal Light	8. Signal Input	11. Power Supply Box
3. Edge Lock	6. Signal Output Air-plug	9. Power Input	12. Power Snaps

## Product Features:

- Full LED encapsulation, IP65 Waterproof Dustproof Anti-collision.
- 60%–95% transmittance, seamless connection.
- Super slim and slight, easy window installation.
- Energy conservation, material heat dissipation.
- Neat frame, front and rear access.
- Stacking, Hoisting installation.



## LED design:

Gluing encapsulation on the LED lamps and strips for defending the collision and preventing water permeant.

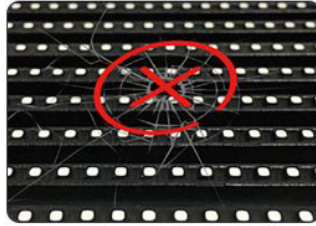
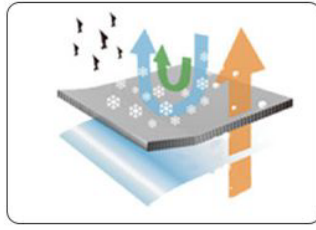
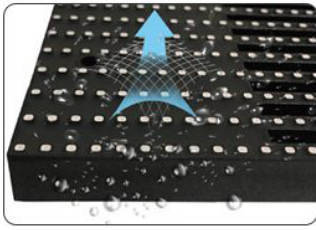

### Excellent protection

1. Gluing encapsulation, anti-collision, waterproof.
2. Voluntarily evaporation from surface.
3. Anti-collision by severe impaction.
4. No damage/No LED failure from the impact.

### Product Installation and maintenance:

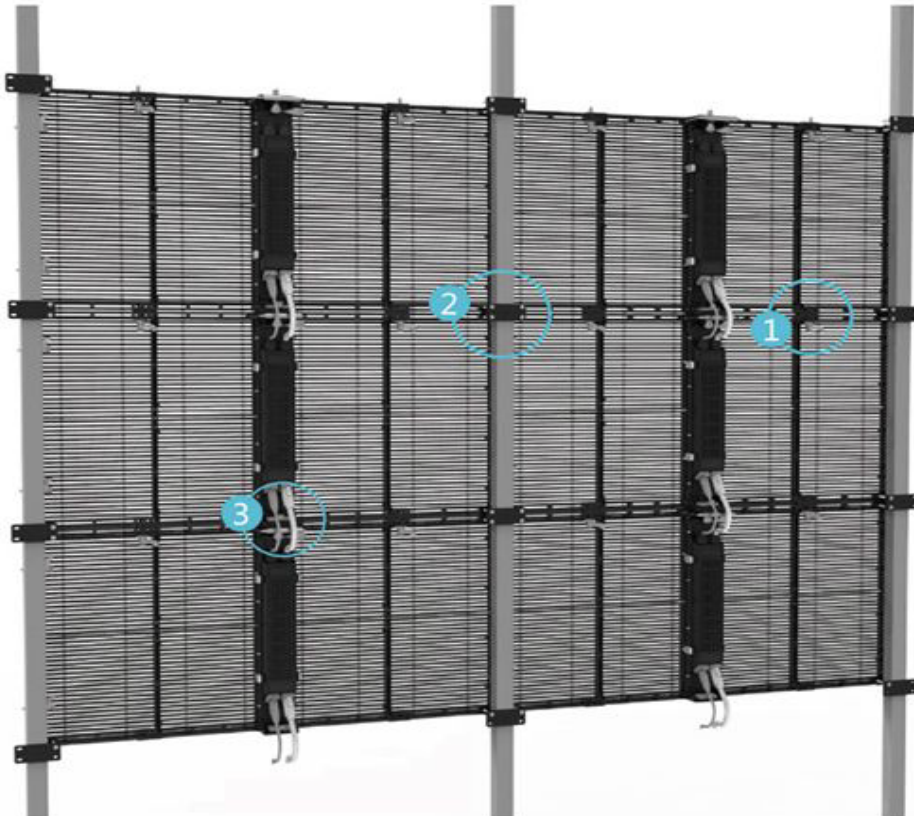

Stacking

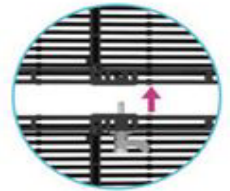

1. Mate lock connection



2. Panels assembling by connectors



3. Main lock connection



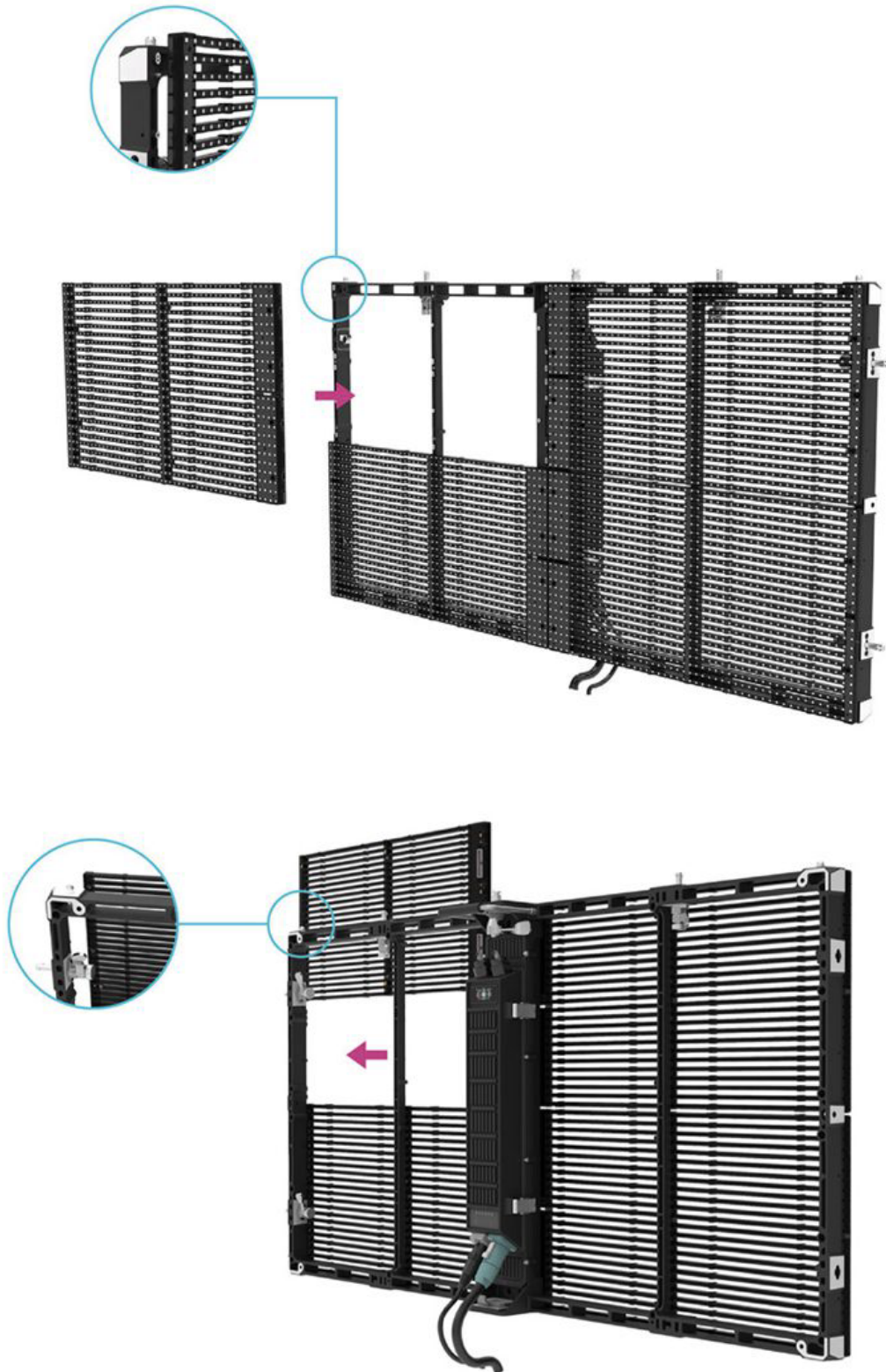

### Front and Rear access:

Tough and durable design, only replace the LED strips by the faulty, saving cost maintenance, easy fixing from front and rear.



### **Easy and Quick for Installation and Maintenance.**

Standardized cast aluminum design with quick locks and connectors for fixed and rental installations. Light weight, ultra –slim, easy for installation and maintenance.

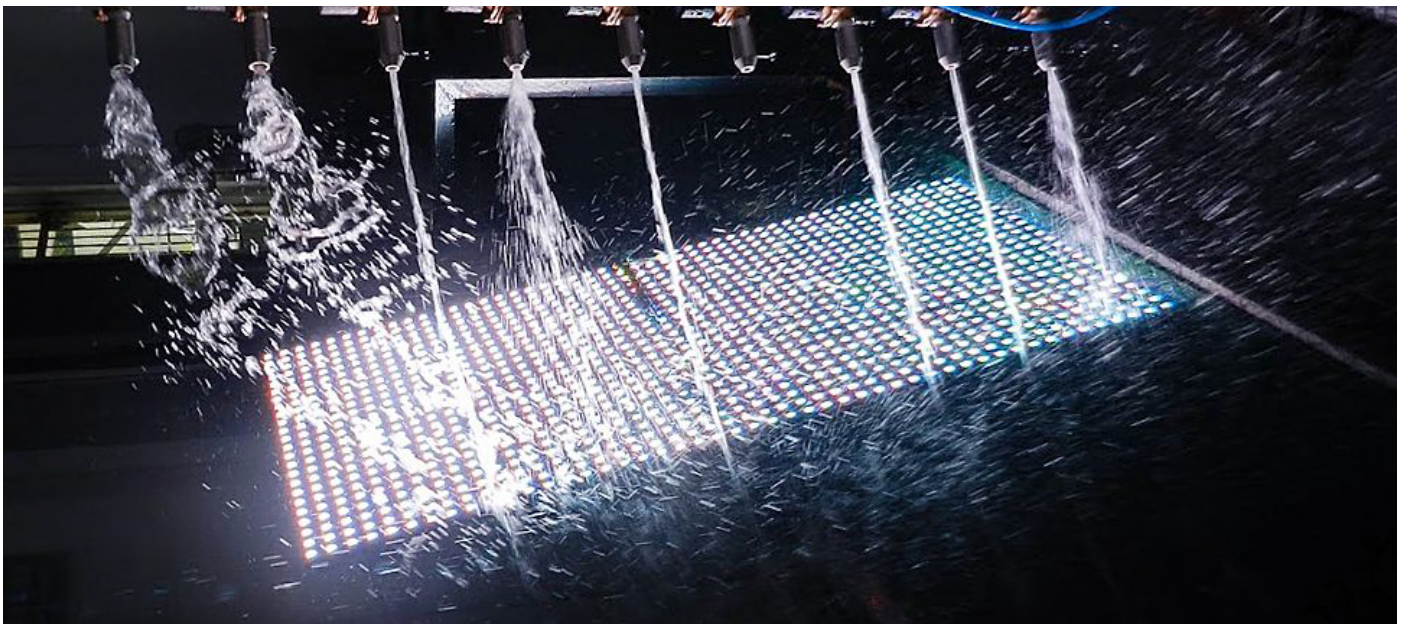

### **High protective performance**

High protective against collision, statics, collision, moisture, dust etc, better ensurance for life long usage.





Cases: Wuhan Optics Valley F.C.



Case: BT Tower in London

**Distributeur Suisse**



Nicolas OBERSON

nico@streaming-live.me

Rte du Péleret 10 D: +41 79 366 81 27

CH - 1691 Villarimboud

**One Display Limited**

Offic Number: +86 755-29949922

Phone/Whatsapp: +86 136-32789913

Email: info@onedisplaygroup.com /

[marketing@onedisplay.net](mailto:marketing@onedisplay.net)

Factory Address: No.1 Dayang 2nd Road,  
Guangming New District, Shenzhen 518132